



# It's All Talk

The Newsletter of Osher at Carnegie Mellon University

## PRESIDENT'S REMARKS

---

### **GREAT NEWS! The project to build our new space in Cyert Hall is well underway.**

The Landau Building Company, whose bid was within our budget, has begun the construction of our new Osher home in Cyert Hall. We are currently making plans to move into our new home and begin in-person learning in September. To keep us all apprised of the progress of the 4.0 project, Landau is providing us with weekly pictures.

### **MORE GOOD NEWS**

On May 27, the Board of Directors approved a recommendation from the Finance Committee to increase its participation in the 4.0 funding project by \$300,000, bringing the Institution's total commitment to the 4.0 project to \$500,000. The Board views this action as appropriate, timely and aligned with its commitment to this critical project.

### **Watching Our Pennies**

As the final plans for the space developed, we worked at the granular level with our architects and Carnegie Mellon project manager to save money where possible — without affecting the quality of our new home and the programming we will provide there. To that end, we are purchasing the furniture, appliances and security system directly, thereby avoiding the contractor's markup. We will also repurpose some of our existing office furnishings and equipment. These actions enable us to responsibly use the kind donations of our members to the 4.0 Project.

### **Our Plans to Return**

Currently, Carnegie Mellon has given us approval to return to campus in September. Currently, CMU and Chatham University are requiring everyone to be vaccinated before coming onto campus. Courses will be offered either in person or on Zoom this fall, not simultaneously.

*Continued on page 7*



Osher Past Presidents Joseph Shirk, John Olmsted and Jim Reitz join President Jan Hawkins, 4.0 Steering Committee Chair, Jeffrey Swoger and Executive Director, Lyn Decker for the symbolic beginning of the demolition of the existing space on level B of Cyert Hall.

## Osher 4.0 Funding Update

First, a huge **thank you** to those listed below for their support of the Osher 4.0 funding project. And kudos to the Osher Board of Directors for their generous infusion of funds. As of June 15, we need to raise a little less than \$400,000 to meet our goal of \$1.36 million.

To reach that goal, we are asking you to pledge any amount you wish over the next five years. By doing so, **the total pledged amount will be credited to the 4.0 project in your name upon receipt of the initial payment.** If you pledged \$100 a year for five years, you would be credited with a donation of \$500. And, we would be \$500 closer to our goal.

Our new home will **materially transform** the 'Osher experience' for students, study leaders and the staff. And, as the floorplan on the center spread shows, it will add a significant social component to our highly regarded program — a program given to us by those who came before us. **NOW**, it's our turn to build a new Osher for ourselves, and, for those who will come after us.

**Together, we can reach our goal!!**

Jeffrey Swoger, Chair Osher 4.0 Steering Committee

---

### Honor Roll of Donors

as of June 15, 2021

#### Naming Opportunities

Janice Hawkins  
John & Eileen Olmsted  
Osher Lifelong Learning Institute at CMU  
Selma Ryave

#### \$20,000 - \$49,999

James & Susan Morris

#### \$10,000 - 19,999

Anonymous  
Jack Buncher Foundation  
William Cadwell  
Beverly & Douglas Jones  
*Gift in kind*  
Gloriana St. Clair  
Linda & Jeffrey Swoger  
*Gift in kind*  
The estate of Florence & Harvey Zeve

#### \$5,000 - \$9,999

Rhoda Eligator  
Ann Giorgi  
Allan & Janet Hribar  
Cheryl Kubelick & Kevin McCann  
Bette Landish & Mark Winer  
Judith Lave  
Marcia & Thomas Morton  
J. Robert & Ruth Myers  
The Learmonth Fund

#### \$1,000 - \$4,999

The Alan L. & Barbara B. Ackerman Foundation  
Rosalie Barsotti  
Bruce & Marian Block  
Steven Calvert  
Owen Cantor  
Donald & Beatrice Churchill Carter  
James & Jacqueline Cimino  
Michael Colligan  
Fred & Stephanie Fall

Lucine Folgueras  
Marcia Frummerman  
Byron & Marcia Gottfried  
Lee & Susan Hershenson  
Janet Hunt  
Elizabeth Martin  
Priscilla McCrady  
Jack Meyers  
Abby Morrison  
Saundra & Eugene Joseph O'Sullivan  
Jack Patzer & Mary Duquin  
Paul Peffer & Leslie Miller  
Frederick Porkolab  
Jim Reitz  
Pete & Deb Rossin  
Signature Financial Planning  
David Steinbach  
Stephen Strelec  
Wealth Management Strategies, Inc.  
Randy Weinberg & Barbara Gengler  
Stanley & Miriam Winikoff  
Kathleen & Gregory Wright

#### \$500 - \$999

Angerman Friedman Family Foundation  
Diane Berman  
Jean Binstock  
Marjorie Carpe  
Alice Chen  
Eugene & Roseanne Colleran  
Jane Cordisco  
Richard & Alva Daffner  
Sherri Davis  
Lyn & Joseph Decker  
Jules Feldman  
Marian Finegold  
Janis Fink  
Bruce & Barbara Goldstein  
John Hawrylak  
Peter & Ann Isaac  
Stanley Levine  
Richard & Susanna Levitt

John Anthony Liberatore  
Christine Michaels  
Anne Molloy & Henry Posner  
Clark Mycoff  
Thomas & Susan Netzer  
Antoinette Petrucci  
Bruce Rabin & Estelle Comay  
Ruth Reidbord  
Thomas & Sheila Savits  
Lee & Myrna Silverman  
Marjorie Smuts  
Jeffrey & Sandra Solomon  
John Spear  
Steele Filipek  
Euphemia Steffey  
Lloyd Stires & Tina Rhoades  
Edwin & Mona Strassburger  
Thomas Waggoner  
Ronald Wetzel  
Joanne Wright  
Kathleen & Gregory Wright

#### \$250 - \$499

Barbara Abraham  
George Arnold  
Rosa Barnett Averbach  
Jeremy Avigad  
Raymond Baum  
Mary Blanchflower  
Joe Bull  
Mark & Leslie Carsman  
Mary & Dan Delaney  
Anna Estop  
Howard & Beverly Filtz  
Suzanne Flood  
Michael & Geraldine Fox  
Paul & Kathleen Gaberson  
Ruth & Alan Garfinkel  
Stuart & Joan Gaul  
Michael & Betty Ginsburg  
Harry & Susan Givelber  
Sally & Martin Goldhaber

Bruce Golightly & Joyce Moore  
Roslyn Goorin  
Jeffrey & Marlene Haus  
Chris Hendrickson  
Robert & Bonnie Isacke  
Janet Jain  
Alan James & Beverly Ann Thornton  
Mark Scott Kamlet & Charlee Mae Brodsky  
David Katz  
Lucille Nicoletta Kenworthy  
Carolyn Kubik & Steele Filipek  
Patricia Lemer  
Kenneth & Barbara McNulty Love  
Robert & Marsha Ganter Ludwig  
David & Barbara Matthews  
Marilyn Meltzer  
Thomas Moore  
Linda Petrilli  
The Pittsburgh Foundation  
William & Nancy Rackoff  
Nagamalli & Meera Ramakrishna  
Richard & Carolyn Reed  
Esther Sales  
George Scheuring  
Gary Schurman  
Joseph & Rosemarie Shirk  
William & Marcia Siegel  
Marlene & Arthur Silverman  
Thalia Snyder  
Loretta Stanish  
Carolyn Stewart  
Peter Sukernek  
Sybil Veeder  
Helen Wilson  
Mark Wilson & Margaret Hamstead

**\$100 - \$249**

Daniel Aleshire  
Stanley & Sarah Angrist  
Norma Artman  
Ann & Frank Augustine  
Len Bass  
Gary & Suzanne Bates  
William Belardi  
Carol Berger  
Lester Berkowitz  
Joan Bernard  
Jacobo Bielak  
Neal Binstock & Karen Woodall  
Michael & Carol Bleier  
Donald & Mary Block  
Marcy Bloom  
Patricia Bloom  
Gloria Bodek  
Brian Bohn  
John & Jane Bolanos  
Daniel & Elizabeth Boyarski  
Charles & Laura Broff  
William Brustein  
Jane Butler  
David & Janet Groom Campbell  
Arlene Carbone-Wiley  
Linda Carter  
Albert & Cynthia Chung  
Paula Ciliberti  
Wallace Clements  
Frederick & Mary Jane Colen  
Alan & Lynne Colker  
Stephen Michael Colodny

Filomena Conti  
Cynthia Cooley  
Gabrielle Corson  
Hanley Cox  
Joyce Culyba  
Denny & Circe Curley  
Lynne Curtis  
Zelda Curtiss  
Marvin & Janice Dash  
Saul Davis  
Susan Davis & John Pierce  
Daniel & Kathleen Deis  
Marylyn Devlin  
Elizabeth Dillon  
A. V. DosSantos  
Colette Dugan  
Edward Dzenis  
John Anthony Dziubek  
Helen Eaton  
Diane Eger  
Sarah & Robert Eldridge  
Thomas Eliseuson  
Mark Emerson  
Joan Ewing  
Susan Farrell  
Barbara Feibelman & Kenneth Orenstein  
Janet Felmeth  
Joan Fereday  
Cheryl Fogarty  
Jennifer Fox Rabold  
Joyce Francis  
Carl Frankel  
J. Peter Freed  
Lorraine Freedlander & Gary Davis  
Bruce Gerald & Ann Gabler  
Chrys Gabrich & Jim Aiello  
Nancy Geilfuss  
Suzanne Gibbon  
Patricia Glosser  
James Greenberg  
William & Kathleen Greenspan  
Susan Gross  
Norton Gusky  
Jeanne Hanchett  
Susan Hansen  
Cecelia Hard & William Hendricks  
Gordon Hargreaves  
Patricia Hauser  
Bin He & Wenjing Ye  
Peggy Allen Heidish  
Robert Heilbronner  
Barbara Hepner  
Thomas & Ellanie Hershberger  
Jeffrey Herzog  
John Houston  
Barry & Judy Huff  
Kathy Hull  
Joan Humphrey  
Patricia Jablonski  
Blair & Lynne Jacobson  
Beverly & Douglas Jones  
Dorothy Kabakeris  
Eleanor Kamin  
Jeffrey Kay  
Amy Kellman  
Judy & Clive Kimblin  
Kathryn Kirk  
Avis Kotovsky  
Robert Kraut & Aya Betensky

Alison Kresh  
Alice & Lewis Kuller  
Ron & Diane Lane  
Tom & Suzanne Lazaroff  
Rita Levine  
Sheldon & Ellie Levine  
Irv Liberman  
Rodney Lipman  
Lawrence Lobl  
Michael Lotze & Joan Harvey  
Mary Ann Love  
Jane MacLeod  
Claus Makowka & Patricia Ulbrich  
Bernard Mallinger  
Barbara Manner  
Jeffrey & Linda Apter Mates  
Marjorie Mazer  
Susan & DeCourcy McIntosh  
Margaret McLean & Stanley Yorsz  
Janet McMaster  
Janet Marie Medvedo  
Alan Meisel & Linda Serody  
William Meisinger  
Tracy Merrick  
Jerry & Gwendolyn Minshall  
Benita Morris  
Gail Murphy  
Robert Netzer  
Louann Neusch  
Thomas Niederberger  
Pamela Noblit  
Nancy Noyes  
Russell Earl Orme  
Theresa Pinsent  
Lisa Platt  
John & Sue Quinn  
Ramen & Martha Raak  
Diane Ramos  
Constance Rapp  
Joyce Rawle-Barniker Berman  
Thomas Michael Regan  
James Reilly  
Richard Rhoton  
Lynn Richards  
Susan Rockman  
Michael & Linda Rosenbaum  
Helen-Faye & Ray Rosenblum  
Marcia Rosenthal  
Richard & Judy Rubinstein  
Edmund S. Ruffin  
Maxine Russ  
Stephen Russell  
Richard & Heidi Russman  
Joan Saroff  
Mahadev Satyanarayanan & Deborah Kelly  
Howard Saunders  
Carolyn Savikas  
Joanne Schreiber  
Patricia Schroder  
Joliane K. Schroeder  
Jolie Schroeder  
Frank & Carolyn Schwarz  
Paul Scott  
Howard Seltman  
Morton Seltman  
Thomas Sheehan  
Sorley Sheinberg  
Rosalyn Sherman

*Continued on page 6*

## Tour Our New Home

### COVID Safety Measures

CMU has installed ultra-violet lights, which kill viruses, in the ventilation systems in all campus buildings, including Cyert Hall. In addition, they have adjusted the systems to use more outside air and less recirculated air.

The spaces on the plan in gray are either part of the CMU internet and communications system or storage area. There are no CMU classrooms on the floor, so we will have minimal contact with students.

### Behind the Design

The floor plan to the right shows how our new space is organized. One of the factors that has guided the design of the space from the beginning is flexibility. It was vitally important to be able to use the space as efficiently as possible. The goal is to hold as many events in the space as possible, including those held either in other parts of the campus, or off-campus.

The entire space will be illuminated by LED lighting, making it bright and welcoming. Extra care has been given to sound control between rooms. The Corridor, Lounge and Activities Room will have a wood composite flooring, while the classrooms and offices will be carpeted.

Furnishings will be modern and comfortable. Tables and chairs stack or nest so spaces can be reconfigured to meet a variety of needs from movie nights with pizza to lectures and the annual meeting.

### New Technology

Special attention has also been given to the technology in the space. Working closely with our team and the architects, the CMU A/V team has designed audio/visual systems that will enhance the use of the different spaces.

New laser projectors in the classrooms will allow bright slide images with the lights on. The presentation systems in the classrooms can be synced when the rooms are combined.

The flat screen monitors in the Members' Lounge and the Activities Room can also be synced for events. And, internet amplifiers will be installed throughout the spaces to assure good reception.

### Questions?

If you have any questions about our new home, access the 4.0 FAQs on our website or contact Jeffrey Swoger, [jcs2032@gmail.com](mailto:jcs2032@gmail.com) or Lyn Decker, [ldecker@andrew.cmu.edu](mailto:ldecker@andrew.cmu.edu). Either of them will be happy to talk with you.

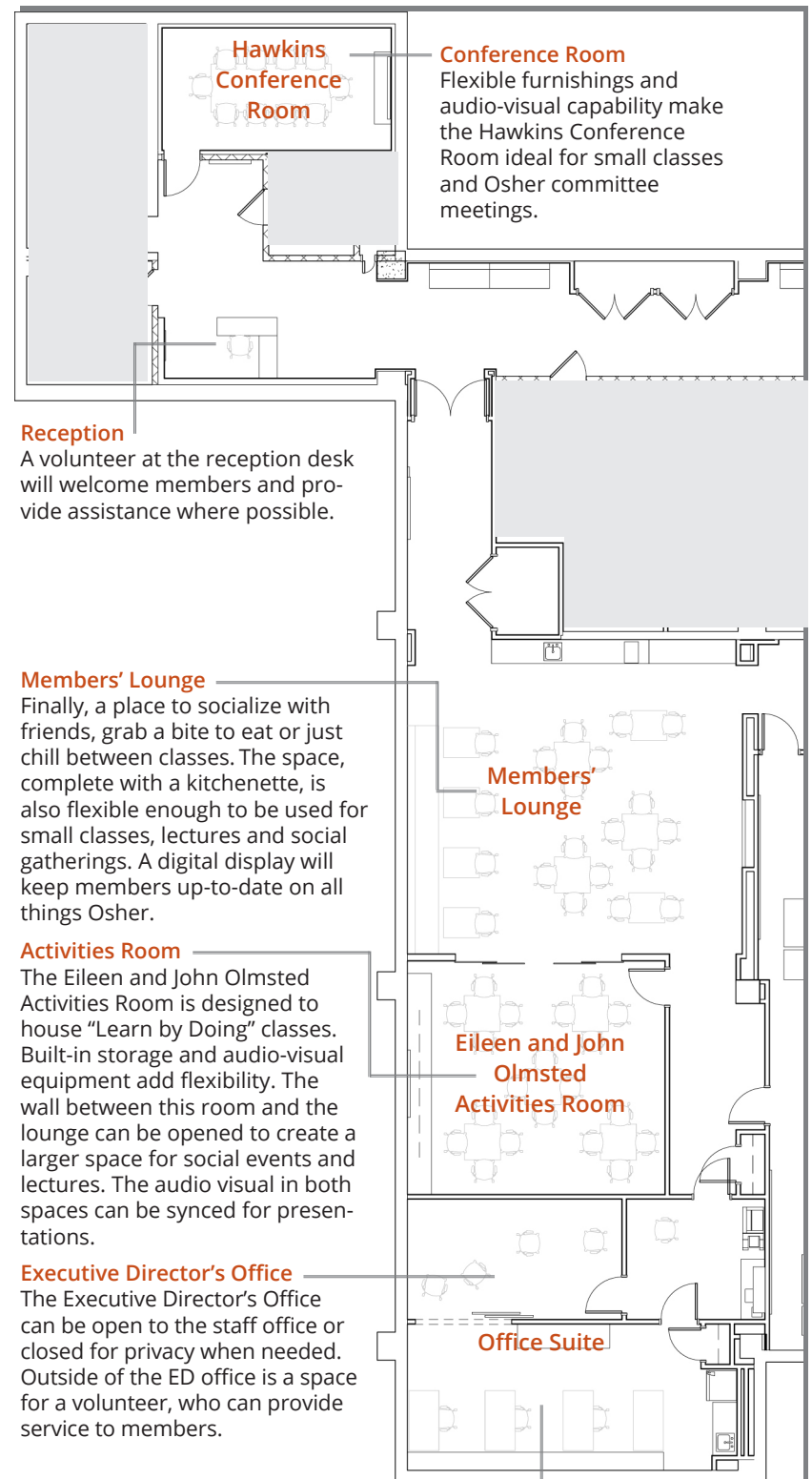

### ◀ East Garage

**Corridor Lounge**

The corridor leading to our new home will contain modern modular seating where members can check email, relax, or catch up with a friend.

**Washrooms**

The washrooms will be remodeled and brought up to ADA standards by the University.\*

W

M

**Small Classroom**  
35 Seats

**Large Classroom**  
49 Seats

**Classrooms**

Similar to our space in Wean Hall, there are two classrooms, one large and one small. The two classrooms will be separated by a folding partition, which will allow them to function as one space, accommodating courses with high enrollment, or as two individual classrooms. Both rooms will be equipped with new audio-visual equipment to enhance the learning environment and an assisted hearing system.

■ Space occupied by CMU

\*There are eight washrooms in close proximity to our space.

**FORBES AVENUE ▼**



## Honor Roll of Donors

*Continued from page 3*

Carl Shipley  
Wilfried & Gail Sieg  
Barbara & Edwin Siegel  
Marjorie Silverman  
Samar Sinharoy  
Robert Skidmore  
Richard Smith & Barbara McMillin  
Raja & Vijayasree Sooriamurthi  
Michaeline Srsic  
Steven Stanek  
Brian Timothy & Carrie Stanny  
Melvin Stein  
Frederick Steinberg  
Rochelle Steiner  
Pamela Stimac  
Dennis Stock  
Lorraine Kosis Strano  
Mary Ann Stuart-Templeton  
Myron & Jill Sussman  
Carol Tabas  
Marcia Taylor  
Barbara Tisherman  
Marilyn & Joseph Turner  
Elizabeth Ubinger  
James Wallace  
Betsy & Charles Watkins  
Anne & Ronald Watzman  
Mark & Deborah Weingarden  
Sheila Werner  
Linda & Bruce Raymond Whiting  
Frances Wilson  
Mark Wilson  
Christine & Mark Witman  
Barbara Wolf  
Carole & Harvey Wolsh  
Beatrice Yaroslavskiy  
Linda & Mike Yatsko  
David Zeve  
Molla Zimmerman

### \$1 - \$99

E. Arnn  
Ziva Aviraz  
Beverly Barkon

Louise & Sheldon Bastacky  
Sherrie & David Beistel  
Nancy C. Bernard  
Shirley Bernstein  
Deborah Bigos  
Cheryl Braver  
Sharman Brisson  
Robert Brown  
Kathy & Francis Burns  
Alice Carnes  
Brenda Castiglione  
Carole Cohen  
Nancy Crouthamel  
Phyllis Davidson  
Patricia Dirienzo  
Paula Engel  
Tibey Falk  
Phyllis & Philip Feinert  
Edward & Roslyn Friedman  
Michael Alan & Zena Gee  
Stanley Glickstein  
Caryle Glosser  
Marilyn & Neal Goldstein  
Marjorie Greenberger  
Eva & Harlan Handler  
Katherine Hast  
Michelle Herwald  
Charles Horne  
Teddi & David Horvitz  
Judith Ismail-Beigi  
Beatrice Jones  
Bill Jones  
Cheryl Kaufman & Stephen Laidhold  
Colleen Kelley  
Mary Ruth Kelsey  
Stephanie Kennedy  
Terry Klein  
B. Kosmach  
Christopher Langhart  
Robert Lasto  
Beverly Lebovitz  
Jeanette Matthews  
Carol Mazziotti  
James & Haydee McCarville  
Beverly Morrow-Jones  
Carol Mueller

Elizabeth Mullaugh  
Pauline & Brian Mullins  
Jay Myers  
Charlene & Stephen Nass  
Carole Neiberg  
Regina Numrich  
Lawrence & Eileen Paper  
Marlene Parrish  
Bessie Pease  
Rita & David Pollock  
Susan Rodaitis  
Bill Roth  
Harvey & Lynn Rubin  
Mary Rudy  
Harold Scheinman  
Barbara Schreiber  
Constance Schwartz  
Susan Segal  
Herschell Segall  
Ruth Silverman  
Adam Sokolic  
Arthur & Arden Cohen Solomon  
Marcia & Melvin Solomon  
Sheila Solomon  
Elaine Stept  
Diane Stewart  
Lance Stiefel  
Nancy Swanson  
Marilyn Swedarsky  
Linda & Jeffrey Swoger  
Barbara Tabachnick  
Susan & Peter Tanzer  
Cheryl Teplitz  
Mark Tierno  
Catherine Tokich  
Jackie Umans  
Claire Vatz  
Jo Ann Wagstaff  
Benjamin Wechsler  
Irwin & Gail Wedner  
Sharon Weiss Dobkin  
John Brian Weller  
Maxine & Clodius Willis  
Susan Young  
Jo Ann Znoy

---

## Naming Opportunities

While the project is only months from completion, there are still a variety of naming opportunities available. Donors who wish to avail themselves of such an opportunity can pledge the amount over five years and they will be credited with the entire amount upon completion of the initial installment.

We will be happy to discuss the naming process with you. Call the Osher office at 412.268.7489 to arrange a conversation.

\$175,000	Large Classroom	\$ 65,000	Conference Room
\$150,000	Members' Lounge	\$ 50,000	Audio Visual System (2)
\$125,000	Small Classroom	\$ 50,000	Executive Director's Office
\$100,000	Activities Room	\$ 25,000	Kitchenette (2)
\$ 75,000	Staff Office		

## GREAT NEWS

*Continued from page 1*

The Cyert Hall remodel is complex and a myriad of issues could occur, potentially impacting the move into our new space. We will continue working diligently to address issues that arise, and to minimize any adverse impacts. Our goal is to make this new space attractive, functional, and welcoming to our members and guests.

### Thank you for your involvement with and contribution to Osher at CMU.

Please review our website and the Weekly Essentials to stay informed about the project's progress.

Jan Hawkins, President

### My 5-Year Pledge to Osher 4.0

I pledge to donate the amount checked below to Osher 4.0 each year for the next five years. I understand that the entire amount of my 5-year pledge will be credited to Osher 4.0 in my name at the time of my pledge. I will receive reminders of my pledge each year until it is paid in full.

Name \_\_\_\_\_

Address \_\_\_\_\_

City \_\_\_\_\_ State \_\_\_\_\_ Zip Code \_\_\_\_\_

Telephone \_\_\_\_\_

Email \_\_\_\_\_

#### 5-Year Pledge Amounts

\$100    \$500    \$ 1,000    \$2,500    \$5,000

\$10,000   Other \$ \_\_\_\_\_

I would like to be contacted by Carnegie Mellon each year to have my pledge paid by credit card. My phone number is \_\_\_\_\_.

I plan to pay my pledges each year by check. I understand that the checks must be made payable to **Carnegie Mellon University with Osher 4.0 in the subject line.**

I would like to talk to someone about naming opportunities. Please contact me at \_\_\_\_\_.

Signature: \_\_\_\_\_ Date \_\_\_\_\_

Mail to: Osher Lifelong Learning Institute at CMU  
5000 Forbes Avenue  
Pittsburgh, PA 15213

## Meet Our Cyert Contractor

Established over 130 years ago, Landau Building Company is a family-owned and operated firm providing construction management and general contracting services in Western Pennsylvania and Northern West Virginia. Now in its fifth generation, Landau specializes in the Higher Education and Healthcare industries.

Some of the firm's projects include: the renovation of Warner Hall, the Schatz Dining Room, The Square, and the Marketplace on the CMU campus; the Mario Lemieux Center for Blood Cancers at the Hillman Cancer Center; and the Pittsburgh Zoo Discovery Pavilion and Children's Zoo.

"Landau Building Company is pleased to be part of the team renovating Cyert Hall. The renovations will provide Osher at CMU members a comfortable space where they can socialize and share their passion for lifelong learning. A few of our employees have participated in the classes and look forward to seeing the program grow," says Sharon Landau, Marketing Director.

We have been impressed with their spirit of cooperation and look forward to a productive working relationship with the Landau team over the coming months.



Construction is underway in our new space



Carnegie Mellon University  
Osher at Carnegie Mellon University  
5000 Forbes Ave  
Pittsburgh, PA 15213

Nonprofit Org.  
U.S. Postage  
**PAID**  
Pittsburgh, PA  
Permit No. 251



"The learning and social opportunities presented by Osher at CMU provide great satisfaction to me. Since joining in 2016, I have focused on giving back through volunteer time. The recent announcement of the opportunity to make designated donations over a 5-year period prompted me to give at a much different level. May our community of lifelong learners continue to thrive. I welcome you to join in building the future of Osher at CMU."

Jan Hawkins